

byannie's

# Lightweight MESH FABRIC Sewing Tutorial

## Lightweight Mesh Fabric

### Level up your sewing game

This tutorial shows a variety of ways to sew and use mesh fabric in your projects. You'll love how easy it is to add this fantastic product to your next project — and how professional it will look.

Mesh is a great choice for pockets, fashion, bags, and more. It is washable, dryer-friendly, durable, and easy to use.

Our 14 brilliant colors match our fold-over elastic and zippers with the same color names for easy mixing and matching!

### What's the big deal about lightweight mesh fabric?

Our Lightweight Mesh fabric is easy to sew and it provides ventilation, visibility and a bit of stretch to your project. It's great for pockets to hold items that need a little bit of air or extra room.

## Slightly stretchy

Crosswise grain = Most stretch

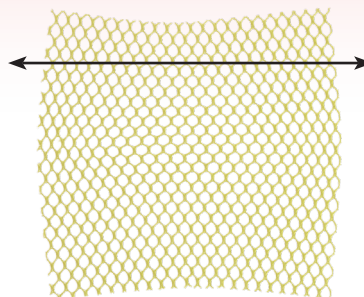

Lengthwise grain = Less stretch

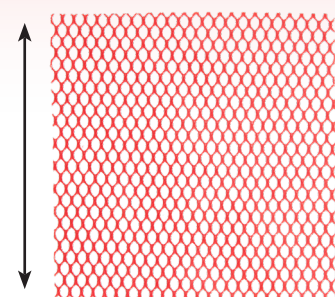

### Stretch is important!

Just like fabric, mesh is more stretchy on the crosswise grain than the lengthwise grain. Pay attention to direction when cutting the pieces for your project. We prefer to cut the width on the more stretchy crosswise grain so that the pocket can expand to hold bulkier contents.

## Finish edges with fold-over elastic

1. Cut fold-over elastic to length of mesh (or shorter for gathered pocket)
2. Open elastic; place raw edge of mesh along fold
3. Fold elastic over mesh; stitch along edge of elastic
4. Gather mesh by stretching the elastic slightly as you sew

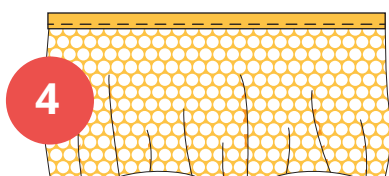
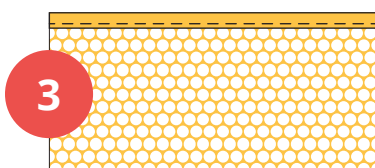
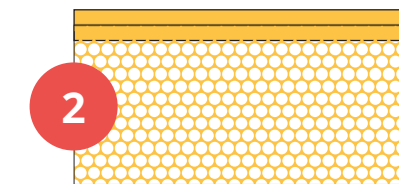
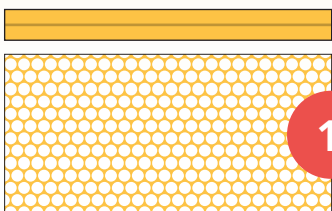

### Professional finish

Fold-over elastic is a colorful elastic with a lengthwise crease down the center which makes folding and binding super easy.

Learn more about fold-over elastic options on page 21.

## Finish edges with French seam

1. With right sides out, sew  $\frac{1}{4}$ " seam; press seam to one side
2. Turn wrong side out, sew  $\frac{3}{8}$ " seam along previous seam
3. Turn right side out; press

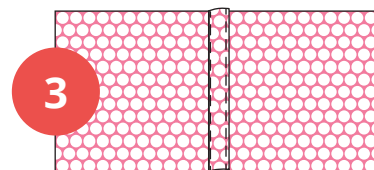
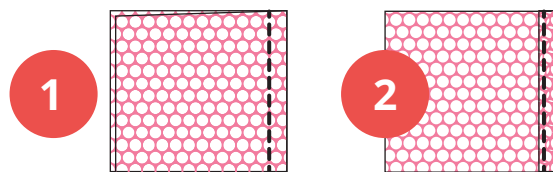

### ByAnnie patterns featuring French seams

- It's A Cinch PBA286
- Meshing Around PBA278

French seams are a great way to sew two pieces of mesh together, ensuring sturdiness and a clean finish.

## Attach zipper directly to mesh

1. With zipper **WRONG** side up, position mesh on top of zipper, allowing long edge of zipper to extend about  $\frac{1}{8}$ " beyond mesh
2. Sew zipper to pocket with a generous  $\frac{1}{4}$ " seam
3. Finger-press zipper tape to front of pocket
4. With zipper **right** side up, sew along very edge of zipper tape to enclose raw edges

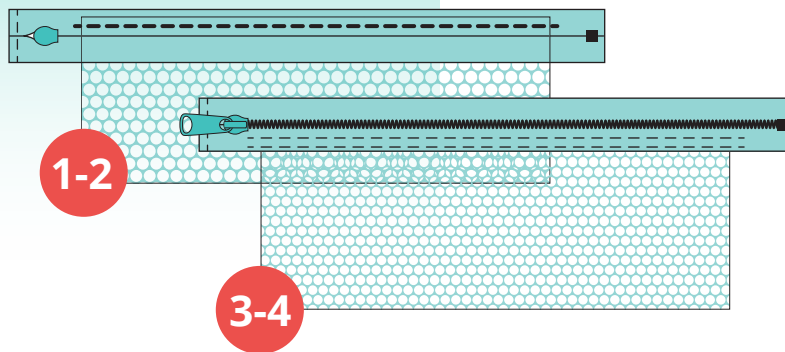

### Looking for tips on zips?

Annie has a number of tutorials on zippers that you can find at [www.ByAnnie.com/digital\\_library](http://www.ByAnnie.com/digital_library). Be sure you're logged in, and then begin watching the 'Zippers Are Easy' video series!

Start meshing around!

Find all 14 colors here:  
[www.ByAnnie.com/mesh-lightweight-18x54](http://www.ByAnnie.com/mesh-lightweight-18x54)

## Finish raw edges with fabric binding

1. Cut fabric 2"H by length of mesh
2. Fold binding in half (right side out); pin (*don't press*)
3. Sew binding to mesh with  $\frac{1}{4}$ " seam
4. Press seam to binding using pressing tool
5. Fold binding to front and stitch along folded edge, enclosing all raw edges

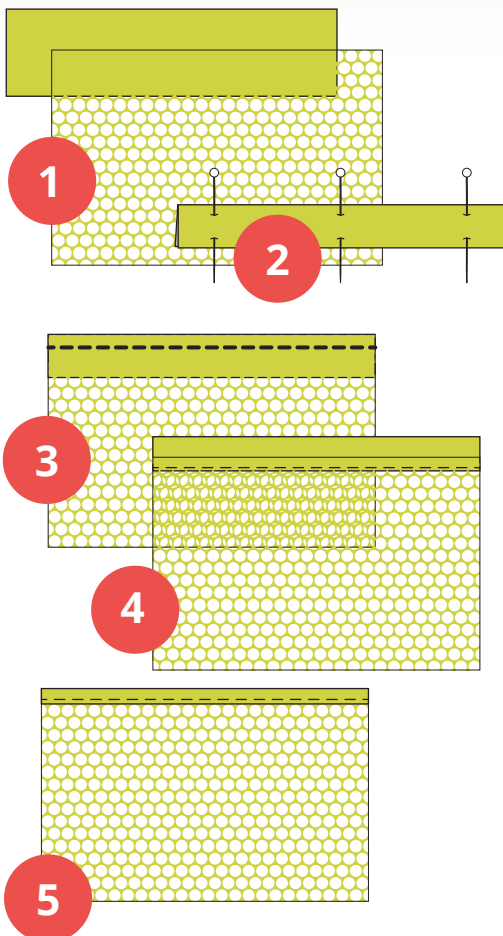

## Attach zipper to bound edge

1. Bind edge of mesh pocket
2. Attach basting tape to back of binding
3. Position mesh pocket on zipper, aligning bottom bound edge with bottom of zipper
4. Sew along top and bottom edges of binding

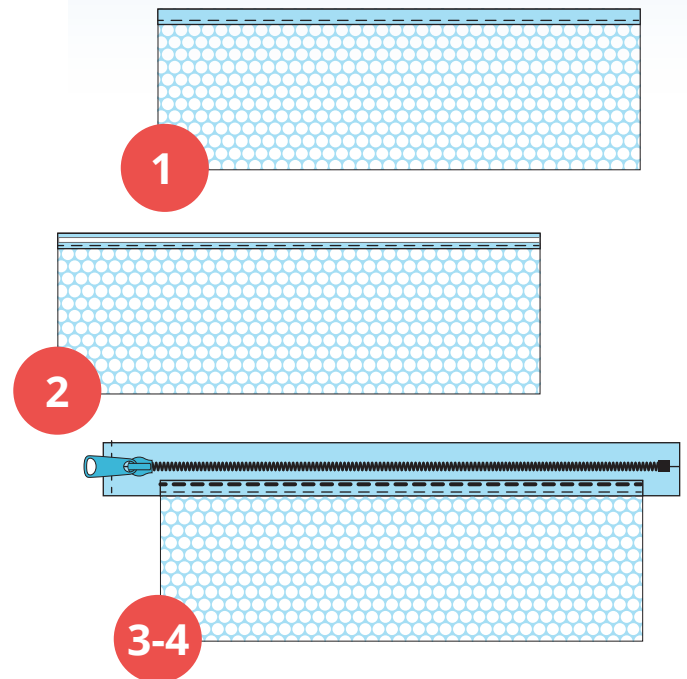

### Sew mesh with Annie!

Learn tips for cutting mesh and follow step-by-step as Annie attaches a zipper to a mesh pocket. Follow along in the Add-on Video for our handy Piecekeeper bag.

